

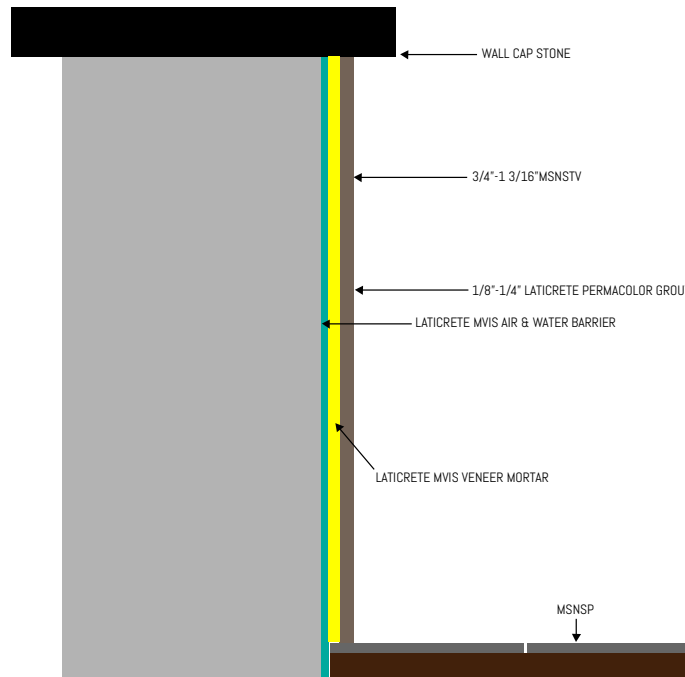

THIN VENEER WALL APPLICATION (CONCRETE CAST-IN PLACE WALL)

MSNSTV - Marmiro Stones Natural Stone Thin Veneer



WARNING	
	Installation of material is sign of acceptance.
	No returns on open crates, custom orders, & products with custom packaging.
	These requirements align with NCMA/MVMA, the Natural Stone Institute, TMS 402/602, ICC-ES, and key ASTM/ANSI standards. Always follow local code and the project engineer's direction.
	Epoxy mesh-backed stone is used to increase the strength of the stone for shipping. All epoxy mesh-backed veneer should be removed with a grinder before installation.
	Laticrete® LATIPOXY® 300 Adhesive is required for long term adhesion of the stone without removal of epoxy meshed-back stone for installation on a concrete wall.

*MSNSTV - MARMIRO STONES NATURAL STONE THIN VENEER

CONCRETE CAST-IN PLACE

1) SUBSTRATE PREP

- Concrete must be 28-day cured, sound, clean, and free of form oils/cures/paints. Mechanically abrade dense/steel-troweled or contaminated surfaces, (industry's best practice).
- Optional, but recommended for bulk-water and crack isolation: Apply Laticrete® MVIS™ Air & Water Barrier to the prepared concrete per Laticrete® DS 661.0; mesh/treat transitions.
- Optional Metal Lath
 - If using metal lath method, please be sure to use galvanized metal lath using corrosive resistant anchors.
- Apply a scratch coat over lath using Laticrete® 3701 Fortified Mortar Bed
 - *Note - On clean, sound concrete/CMU, Laticrete® generally promotes direct-bond Laticrete® MVIS installations (no lath) with their mortars; lath/scratch is an alternative when the wall is contaminated or can't be adequately prepared.

2) SETTING MORTARS (SELECT PER SUBSTRATE / CONDITIONS)

- Apply One of the following mortars based on application:
 - Laticrete® MVIS™ Veneer Mortar (polymer-fortified, non-sag).
 - Laticrete® MVIS™ Hi-Bond Veneer Mortar (high-bond, exterior, long open time).
 - Laticrete® 254 PLATINUM™ (alternative for dense concrete/critical bonds).

3) SETTING THE STONE

- Use one of the following Laticrete® setting mortars (mix with water only; follow DS specs):
 - MVIS™ Veneer Mortar (polymer-fortified, non-sag) or MVIS™ Hi-Bond Veneer Mortar for high-bond, exterior work.
 - For exceptionally dense/smooth concrete, 254 PLATINUM™ is an approved alternative. This should be used for water applications.
 - ▶Trowel a full bed and back-butter each unit to achieve complete coverage; beat in. (ASTM C1780)

4) EPOXY-BACKED STONE

Choose one of these options below:

a. Laticrete® LATIPOXY® 300

- Laticrete® LATIPOXY® 300 Adhesive is required for long term adhesion of stone to concrete wall.
- Mixing: Pour LATIPOXY® 300 Adhesive Part A and Part B into a clean mixing pail and mix thoroughly. Add LATIPOXY® 300 Part C Filler Powder and mix to a smooth, trowelable consistency. Mortar is ready for use immediately after mixing.
- Application: Apply mortar to the substrate with the flat side of the trowel, pressing firmly to work into surface. Comb on additional mortar with the notched side.

b. Remove back mesh with a grinder.

- Then proceed using one of the mortars listed in #3 above.

5) MORTAR JOINT OPTIONS

a. Place MSNSTV (typical is 4" & 6" height material) with no mortar joint, creating a tight fit.

b. MSNSTV 3"/6"/9" system is designed for a 3/8" grout joint.

- Be sure to use spacers to maintain consistent joint spacing.
- Before starting to grout, remove spacers and debris in grout joints and remove dust and dirt using a wet sponge. Do not leave water sitting in joints.
- Mixing: Use approximately 2.4–2.6 quarts (2.3 L–2.5 L) of clean potable water for 25 lbs. (11.3 kg) of PERMACOLOR® Grout. Place water in a clean mixing container and add grout powder. Mix with a slow speed drill mixer (300 rpm) for one minute. Wait for five minutes and remix with drill for one minute.
- Apply: Using a grout bag, apply grout to joints filling completely. Use a 3/8" flat slicker jointer or jointing tool to give a concave look.
- Cleaning: Begin initial cleaning by lightly wiping down entire area to be cleaned with a damp sponge. Wash with a damp sponge (not wet). Work diagonally toward the joints. Allow to dry three hours at 70°F, (warmer days will have a faster dry time). For second cleaning, use a damp sponge or dry cloth to remove remaining grout haze.

6) BEST PRACTICES

- a. Base clearances - Maintain clearances to shed water: Typically, 4" above earth, 2" above paved, ½" above walking surfaces, sharing the same foundation.
- b. Use MSNSTV: Pull from multiple crates for blending. Do not install saturated/frozen stone.
- c. Exterior installations should target essentially 100% contact with tight edges; avoid "center void doughnuts" aka: picture framing.
- d. Follow product temperature limits: Protect from freezing, rapid drying, or direct rain until cured.
- e. Use polymer-modified mortars for exterior wall applications.
- f. Do not bridge structural/expansion joints with mortar or stone; continue the joint through the veneer with backer-rod & sealant.
- g. Do not rely on a thin "dot and dab." Full coverage is required. Periodically pull a piece to check.
- h. Do not set stone in freezing temperatures, on saturated substrates, or in driving rain—follow mortar product temperature/cure limits.