

THIN VENEER WALL APPLICATION

MSNSTV – Marmiro Stones Natural Stone Thin Veneer - Masonry Wall Installation

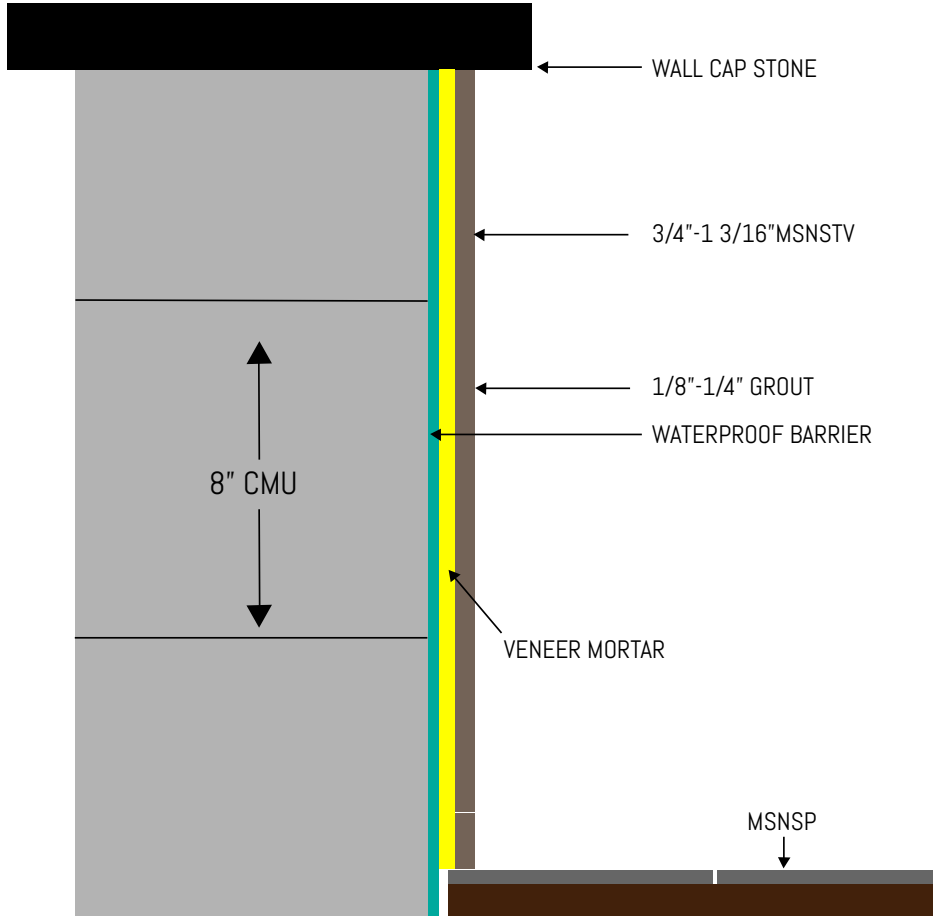

Epoxy-mesh backed stone is used to increase the strength of stone due to natural veining.

Laticrete® LATIPOXY® 300 Adhesive is required for long term adhesion of stone to concrete wall.



Installation

On existing CMU or concrete wall

1. Apply HYDRO BAN® waterproofing system directly to the wall.
 - A. Application types but not limited to the following:
 - Raised spa wall with spillway
 - Water feature walls
 - Raised gunitite walls
 - Tanning ledges or sun shelf
2. Apply one of the following approved mortars once waterproofing has dried:
 - Laticrete® 254 Platinum
 - Laticrete® 247 Titanium
 - Laticrete® Multimax™ Lite
3. For epoxy- back stone follow the following instructions. If no epoxy is present on stone skip to next step.

Laticrete® LATIPOXY® 300 Adhesive is required for long term adhesion of stone to concrete wall.

1. Rough or uneven concrete surfaces should be made smooth with Portland Cement Underlayment to provide a wood float (or better) finish.
 2. Mixing: Pour LATIPOXY 300 Adhesive Part A and Part B into a clean mixing pail and mix thoroughly. Add LATIPOXY 300 Part C Filler Powder and mix to a smooth, trowelable consistency. Mortar is ready for use immediately after mixing.
 3. Application: Apply mortar to the substrate with the flat side of the trowel, pressing firmly to work into surface. Comb on additional mortar with the notched side.
4. Apply MSNSTV in a leveled line, working from the bottom up.
 5. Perform all cuts with a grinder using a diamond blade.
 6. Mortar Joint Options:
 - A. Place MSNSTV (typical is 4" & 6" height material) with no mortar joint, creating a tight fit.
 - B. MSNSTV 3"-6"-9" system is designed for a 3/8" grout joint.
1. Be sure to use spacers to maintain consistent joint spacing.
 2. Before starting to grout, remove spacers and debris in grout joints and remove dust and dirt using a wet sponge. Do not leave water standing in joints.
 3. Mixing: Use approximately 2.4 – 2.6 quarts (2.3 L – 2.5 L) of clean potable water for 25 lbs (11.3 kg) of PERMACOLOR® Grout. Place water in a clean mixing container and add grout powder. Mix with a slow speed drill mixer (300 rpm) for 1 minute. Wait for 5 minutes and remix with drill for 1 minute.
 4. Apply: Using a grout bag apply grout to joints filing completely. Use a 3/8" slicker trowel or jointing tool to give a concave look.
 5. Cleaning: Begin initial cleaning by lightly wiping down entire area to be cleaned with a damp sponge. Wash with a damp sponge (not wet). Work diagonally to the joints. Allow to dry 3 hours at 70°F (warmer days will have a faster dry time). For second cleaning use a damp sponge or dry cloth to remove remaining grout haze.